



The Manual Call Point MCP-C652 is provided to manually trigger the Fire Alarm System. They are constructed in red ABS plastic housing, and are usually installed in areas like corridors and exit staircases.

They are alarm latching, with LED alarm indication provided as standard. Every unit is provided with a special 'Key' to facilitate the resetting of the unit during testing or routine inspection.

### Features :-

- Complies to the latest EN 54-11 Standards
- Non-breaking resettable 'Glass' via special key
- LED light provided to indicate activation
- Plug-in type of Termination for ease of Installation
- Optional Transparent Flip Cover available  
(To be ordered separately)

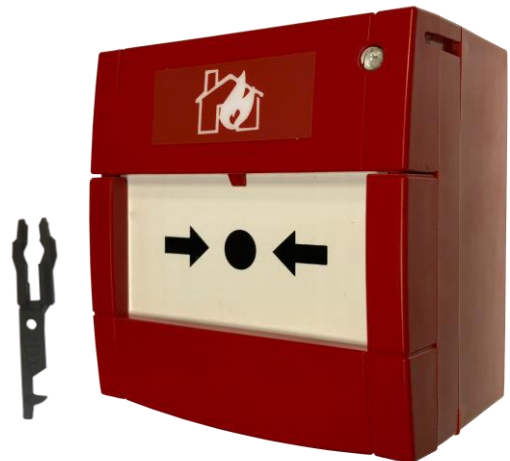

Manual Call Point , Model : MCP-C652

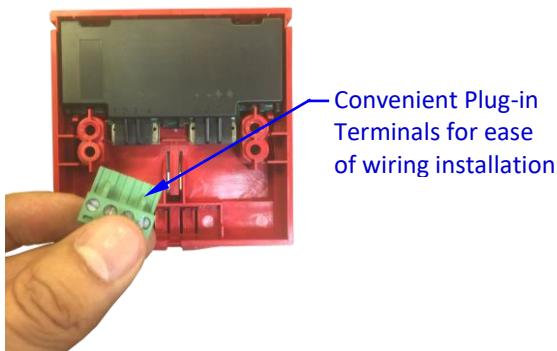

Convenient Plug-in Terminals for ease of wiring installation

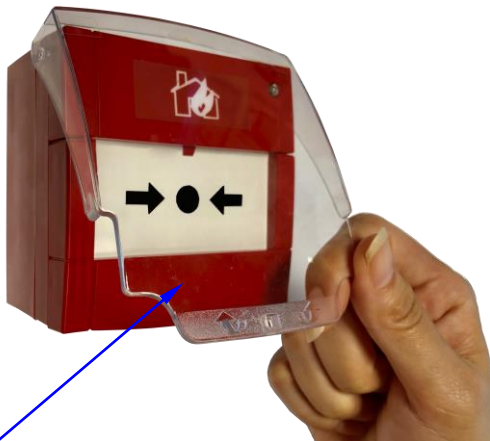

Transparent Flip Cover may be added for extra protection against accidental activation  
(Optional - To Be Ordered Separately)

Technical Specifications :-	
Operation Voltage	24VDC
Monitoring Current	0mA
Alarm Current	46.3mA @ 24VDC
Operating Temperature	-10 °C to +55°C
Relative Humidity	95%, Non-Condensing
Ingress Protection	IP 43
Dimension in mm. (Ht. x Width x Depth)	89.5 x 87 x 26 (without Back Box) 89.5 x 87 x 58 (with Back Box)
Weight	137g (with Back Box) 84g (without Back Box)
Alarm Contact (Terminal 1,2 and 3,4)	470 Ω with LED
Alarm Contact (Terminal 5,6 and 7,8)	N/O without Resistor & LED
<p style="text-align: center;"><b>Typical Circuitry</b></p>	

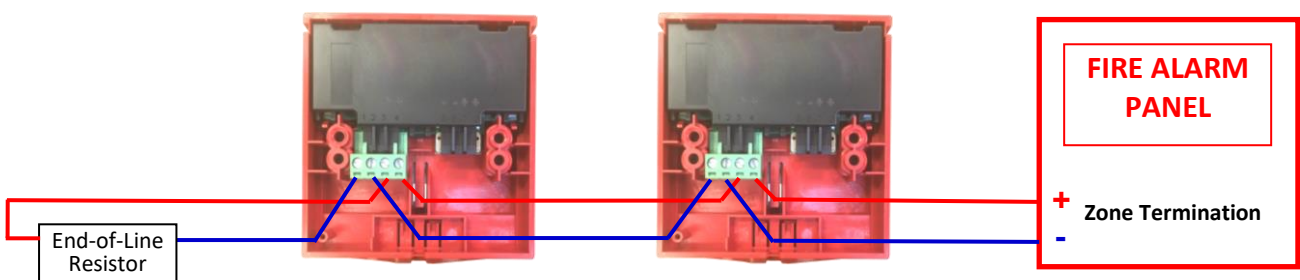

TYPICAL TERMINATION DIAGRAM (Using Terminal 1,2 and 3,4)



## Innovative Resettable 'Break-glass'.....

....with the look and feel of a real Break-glass, but without the trouble of replacement after activation....

### TO ACTIVATE ALARM :-

Position Finger  
onto 'Break-glass'



- 1) Manual Call Point in its normal condition.
- 2) Position your finger onto the centre of the Break-glass'.

Press Hard to Activate.

The Yellow Marking  
will be shown once the  
Call Point is activated.

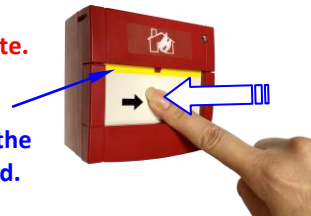

- 3) To activate, press the 'Break-glass' and it will snap backwards.
- 4) Yellow marking will be shown at the top to indicate activation.
- 5) The Alarm Contact Signal shall be activated.

### TO 'RESET' MANUAL CALL POINT :-

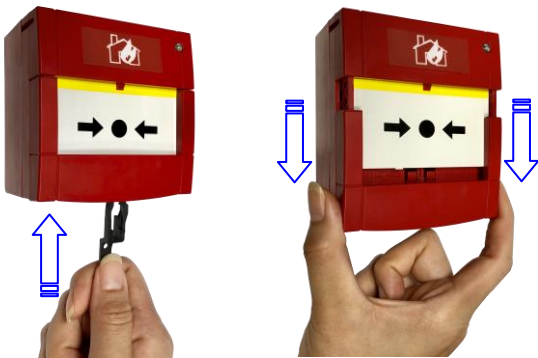

- 6) To reset, insert the special Key at the bottom reset keyhole of the Manual Call Point.
- 7) Slid down the casing of the Manual Call Point downwards to reset the position of the 'Break-glass'.

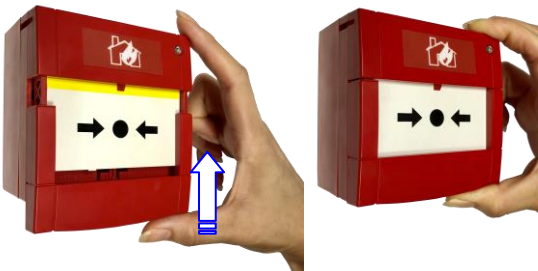

- 8) Press and slid back the casing to its original position.
- 9) Once the casing is snapped back, the Manual Call Point is properly 'Reset' to its normal condition.

## Multron Systems Pte Ltd

217 Kallang Bahru, Multron Building, Singapore 339 347

6395 6868  
6395 6869

info@ multron.com  
www. multron. com

